

Ex de Flame Proof / Ex tD Dust Certified Temperature Assembly Spring Loaded Nipple Connection MODEL No: TC20SPRTA MIMS Thermocouple Head-mounted Temperature Switch

MATERIAL: ALUMINIUM ALLOY
DEGREE OF PROTECTION : IP66

SPRING LOADED

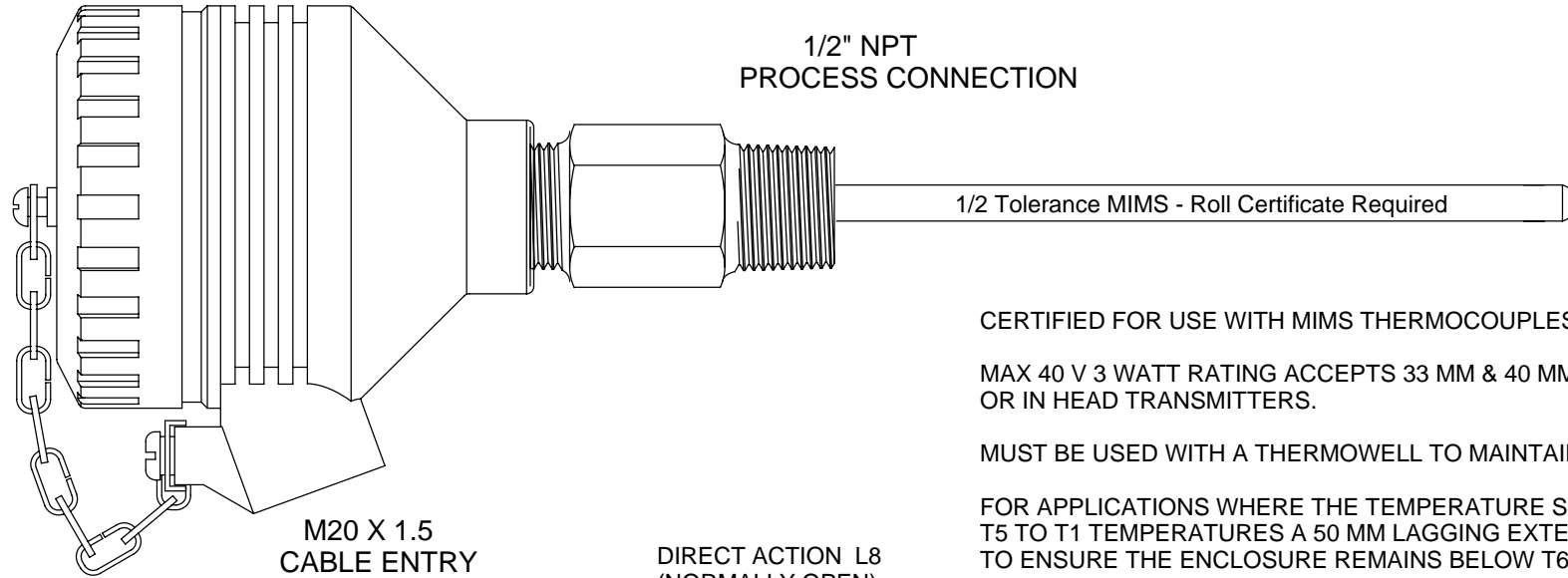
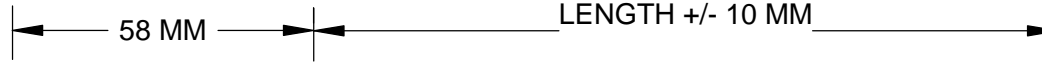

CERTIFIED FOR USE WITH MIMS THERMOCOUPLES AND MIMS RTD SENSORS

MAX 40 V 3 WATT RATING ACCEPTS 33 MM & 40 MM CENTRE TERMINAL BLOCKS OR IN HEAD TRANSMITTERS.

MUST BE USED WITH A THERMOWELL TO MAINTAIN IP66 RATING.

FOR APPLICATIONS WHERE THE TEMPERATURE SENSOR IS TO BE USED IN T5 TO T1 TEMPERATURES A 50 MM LAGGING EXTENTION SHALL BE FITTED TO ENSURE THE ENCLOSURE REMAINS BELOW T6 TEMPERATURE RATING.

IECEX certified Ex de, IIC T6 IP66 or Ex tD A21 T6 IP66

IECEX Certificate of Conformance No : IECEX TSA 09.0045X
for complete assembly

DIRECT ACTION L8
(NORMALLY OPEN)

REVERSE ACTION
(FAIL SAFE) L7
(NORMALLY CLOSED)

Power Supply: 18-30V AC/DC

Input: Type K thermocouple

Output: Relay contact C/O rated at
10A / 32V AC/DC resistive

Relay action: Direct or reverse (Fail safe) is solder pad selectable

Option: Latching relay (lockout)

MODEL NO. TC TS Ex d

FACTORY SET WHEN RANGE SPECIFIED

RANGE _____

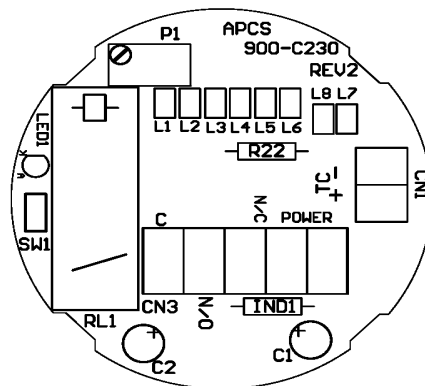

TEMPERATURE CONTROLS PTY LTD

QUALITY ENDORSED COMPANY
Certificate No: QEC 14412
AS/NZS 9001:2008

CONDITIONS

THIS DRAWING IS OUR EXCLUSIVE PROPERTY AND MUST NOT BE COPIED OR HANDED TO ANY OTHER PARTIES WITH OUT WRITTEN PERMISSION. IT SHALL BE RETURNED UPON REQUEST

SYDNEY: 7 YAMMA ST SEFTON , NSW 2162
PHONE: (02) 9721 8644 FAX : (02) 9738 9339
MELBOURNE: 8/280 Whitehall St YARRAVILLE, VIC 3013
PHONE: (03) 9687 0000 FAX : (03) 9687 1900
BRISBANE: 28A/125 Kerry Road, Archerfield Qld 4108
PHONE: 0418 222 868
EMAIL: sales@temperature.com.au

TITLE **Ex de / Ex tD ASSEMBLY
TEMPERATURE SWITCH**

SIZE : A4	DATE : 21/11/13	DWG NO : SD 827
SCALE : NTS	DRAWING BY R.B	REV : 01